

# ***Prime Inwood Corner Retail Available*** ***5008 Broadway*** ***Corner of 213<sup>th</sup> Street***

## **Corner Space (#105)**

***1,687 Square Feet Ground***

***1,101 Square Feet Basement***

***Over 50' of Corner Frontage***

## **Inline Space (#104)**

***603 Square Feet***

***12' Frontage & 10+' Ceilings***

***Great Light from Skylight***

Two stores available for lease together or separately. White boxed spaces that are in a great section of Inwood. Corner space was previously a pub and has over 50' of frontage and a storage basement. The inline space was a bridal store and offers great light, high ceilings and a boutique feel. All uses considered for both spaces and available for immediate possession.

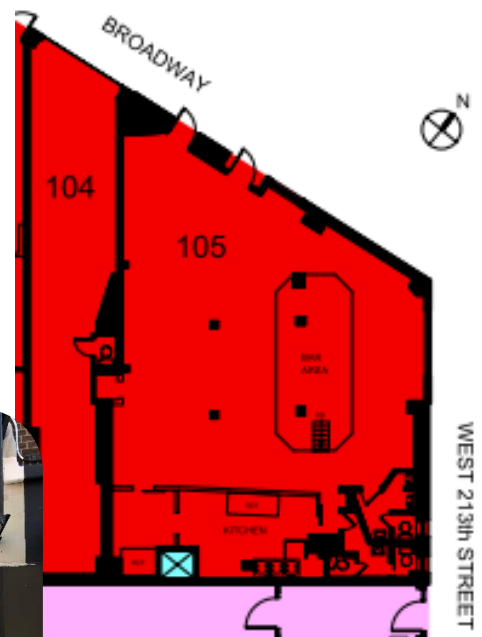

***For More Information Contact Exclusive Broker:***

***Jeffrey Angel***  
***212-719-7017***

***Jeffrey.angel@resnewyork.com***



Although the information contained herein has been provided by sources that we deem reliable, we do not guarantee its accuracy in any way. No expressed nor implied warranties are made as to the accuracy of any/and all of the information contained herein and it should not be relied upon in any way by a prospective tenant. All information contained herein should be independently verified prior to anyone entering into any form of legally binding agreement to purchase, lease or otherwise procure the premises or situation presented herein. All information is subject to change or withdrawal without reason or notice. This flyer may contain errors and/or omissions for which RES, nor the landlord shall be held responsible for in any way.

# Neighborhood Information

## 5008 Broadway

Great neighborhood including and major draws such as Columbia University's Baker Athletic Complex with Wien Stadium and across the street from Isham Park and Inwood Hill Park.

Neighbors include: Grandpas' Brick Oven Pizza • Lalpe Hair • Manhattan Mini Storage • Mt Sinai Doctors Urgent Care • Chocnyc • Royal Pharmacy • Liffy II Bar • MRFU Chophouse

DEMOGRAPHIC HIGHLIGHTS *	
Total Population	41,958
Male	19,376
Female	22,582
Median Age	36.9
Hispanic/Latino	29,297
Not Hispanic/Latino	12,661
White alone	8,116
Black or African American Alone	2,647
Asian Alone	1,198
Total Households	15,923
Median HH Income	\$54,683
Mean HH Income	\$73,054
Per Capita Income	\$29,989
Total Housing Units	16,470
Owner Occupied	1,493
Renter Occupied	14,430
* Provided by Popfactfinder.planning.nyc.gov	

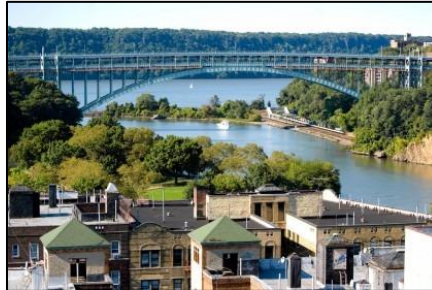

MTA TRANSIT RIDERSHIP INFO **	
Bus Stop @ @213th St	Bx7 & Bx20
Subway 2019	207th Street – A Train
Avg Weekday	5,890
Avg Weekend	6,425
Annual Total	1,853,146
Subway 2019	215th Street – 1 Train
Avg Weekday	1,718
Avg Weekend	1,663
Annual Total	517,505
** Provided by MTA.info	

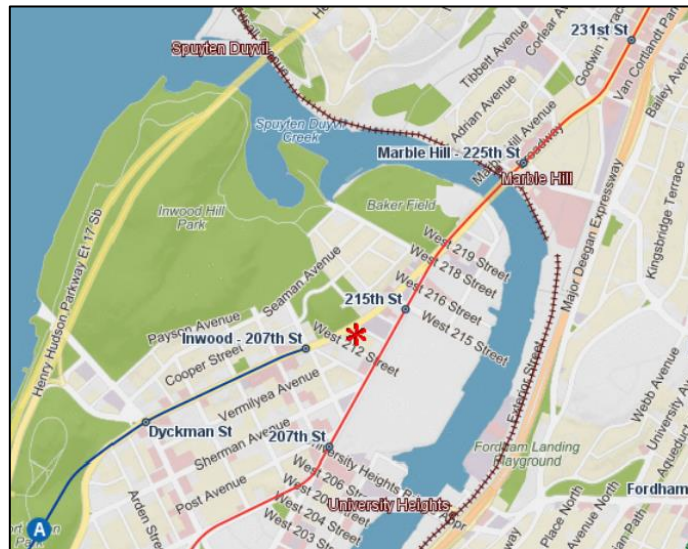

For More Information Contact Exclusive Broker:

**Jeffrey Angel**

**212-719-7017**

**Jeffrey.angel@resnewyork.com**



Although the information contained herein has been provided by sources that we deem reliable, we do not guarantee its accuracy in any way. No expressed nor implied warranties are made as to the accuracy of any/all of the information contained herein and it should not be relied upon in any way by a prospective tenant. All information contained herein should be independently verified prior to anyone entering into any form of legally binding agreement to purchase, lease or otherwise procure the premises or situation presented herein. All information is subject to change or withdrawal without reason or notice. This flyer may contain errors and/or omissions for which RES, nor the landlord shall be held responsible for in any way.