

Prime NoLita / Little Italy Restaurant Available

384 Broome Street

Between Mulberry / Mott Streets

Previously October Restaurant

Approximately 750 sf on Ground

High Traffic Location

Approximately 500 sf in Basement

Brand New Installation Fully Intact

Great Quick Service Opportunity

Venting & Gas in Place

Asking Rent Upon Request

Great Frontage Just Off Mulberry

This restaurant installation is only about 2 years old and offers a great situation complete with a hood, HVAC, gas line and upgraded electric. Excellent frontage with French windows to open up and opportunity for sidewalk café. Comes with some non-contiguous basement which has a walk-in, storage and sink.

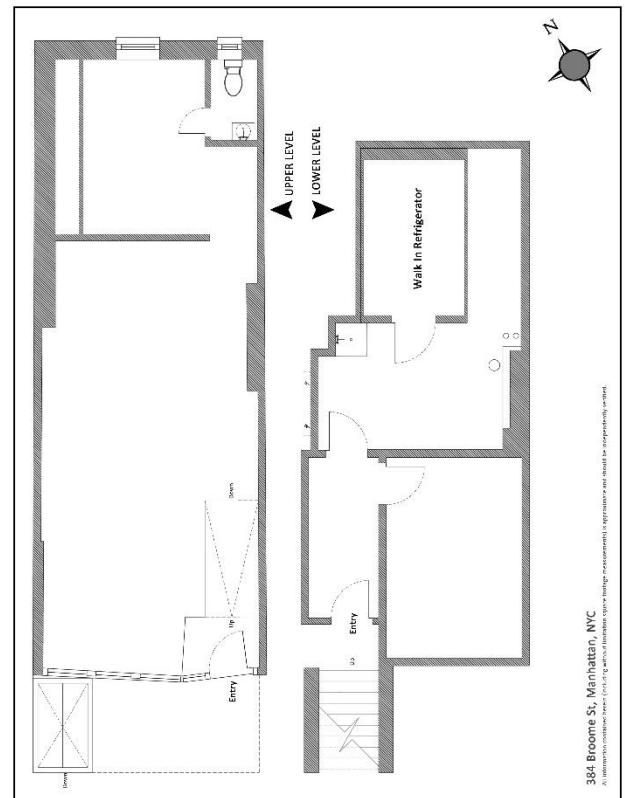

For More Information Contact Exclusive Broker:

Jeffrey Angel
212-719-7017
Jeffrey.angel@resnewyork.com

Cara Santamaria
917-833-4427
Cara@resnewyork.com



The information contained herein has been provided by sources that we deem reliable. However, no expressed or implied warranties are made as to the accuracy of the information and it should not be relied upon in any way. All information contained herein should be independently verified prior to anyone entering into any form of legal binding agreement to purchase, lease or otherwise procure the premises or situation presented herein. Information is subject to change or withdrawal without notice and may contain errors and/or omissions. Owner, RES nor any of their agents do not guaranty any information contained herein.

Neighborhood Information

384 Broome Street

Very high trafficked intersection where Little Italy meets Nolita with both tourists and locals in the area. Amazing new places opening up nearby like Seamore's on the corner of Mulberry, Mimi Cheng's Dumplings, Cha Cha Matcha and Greekologies recently opening in the area. Great 7 day a week location.

Neighbors include: Seamore's Restaurant • Café Roma • Mimi's Dumplings • Grotta Azzura Ristorante Sweetgreens • Mo Il Gelato • Wild Ginger • Greekologies • Cha Cha Matcha • Soho Strength Lab

SOHO STRENGTH LAB

sweetgreen

Wild Ginger

Pan-Asian Vegan Specialties



MIMI CHENG'S
dumplings



For More Information Contact Exclusive Broker:

Jeffrey Angel
212-719-7017

Jeffrey.angel@resnewyork.com

Cara Santamaria
917-833-4427

Cara@resnewyork.com

R·E·S

Although the information contained herein has been provided by sources that we deem reliable, we do not guarantee its accuracy in any way. No expressed nor implied warranties are made as to the accuracy of any/and all of the information contained herein and it should not be relied upon in any way by a prospective tenant. All information contained herein should be independently verified prior to anyone entering into a form of legal binding agreement to purchase, lease or otherwise procure the premises or situation presented herein. All information is subject to change or withdrawal without reason or notice. This flyer may contain errors and/or omissions for which RES, nor the landlord shall be held responsible for in any way.