

Unique Retail Opportunity in West Village **41 Eighth Avenue**

Just South of West 4th Street (Reggie Fitzgerald Triangle)

A very unique retail opportunity at the crossroads of the West Village meeting the Meatpacking District. Very solid visibility with about 17' of frontage just off the triangle at West 4th Street so there is great exposure and solid traffic. A one of a kind opportunity to lease about 200 square feet for any kind of retail, non vented food use or any other type of business that is looking for a marginal footprint in a great location.

Approximately 200 Square Feet

Asking Rent Upon Request

About 17' Frontage

All Uses Considered (non-vented)

Prime West Village Location

Possession Is Immediate

Neighbors include: Manley's Spirits • Art Bar • Aux Merveilleux de Fred • Li Lae Chocolates Tavern on Jane • The Corner Bistro • Sharaka • Echelon Cycles • Jackson Square Park and More

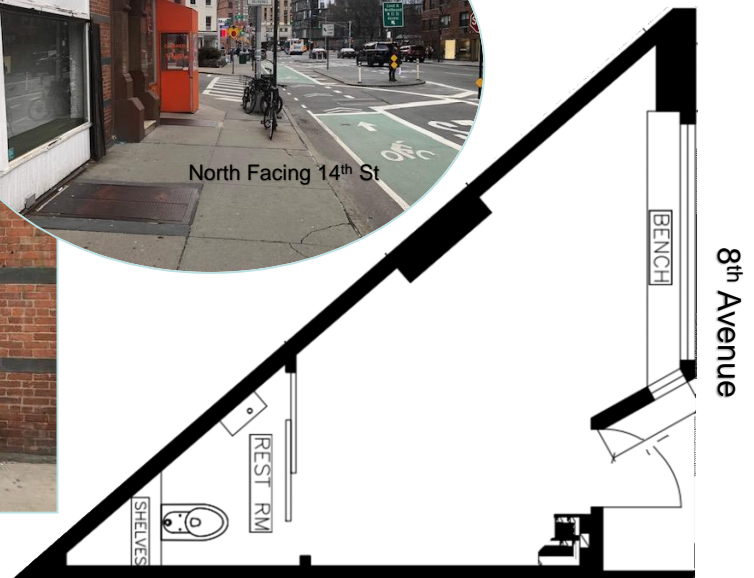

For More Information Please Contact
Jeffrey Angel
212-719-7017

Jeffrey.angel@resnewyork.com



The information contained herein has been provided by sources that we deem reliable. However, no expressed or implied warranties are made as to the accuracy of the information and it should not be relied upon in any way. All information contained herein, including but not limited to square footage, zoning, uses, availability and/or all other information, should be independently verified prior to anyone entering into a form of legal binding agreement to purchase, lease or otherwise procure the premises presented herein. Information is subject to change or withdrawal without notice and may contain errors and/or omissions.